

Infopipe® G3R System Services

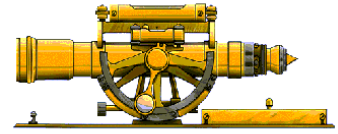

Our **Grid-to-Grid Georeferencing (G3R)** is a Complex-Geometry Spatial Process that smoothly and continuously transforms data on one grid system to another.

We know that you have substantially invested in your grid by adding important associated information. Vendors of Public Land Survey System (PLSS) Grid have created data from USGS and BLM data in the past. A vendor's stable grid will not match current BLM data because the BLM has changed their data. It would be costly to change grid in order to use BLM Lots-Tracts and County Parcels. However, you may want to employ the latest BLM Lots-Tracts and County Parcels in your maps. With our G3R Service, you get to keep your investment and use the new data. G3R transforms these data to the stable PLSS Grid used by your operations.

Infopipe's **UNIQUE** G3R service Spatially Adjusts data from one grid to another allowing you to maintain the value of your grid investment. Never create lots, tracts, aliquots, or parcels by hand again!

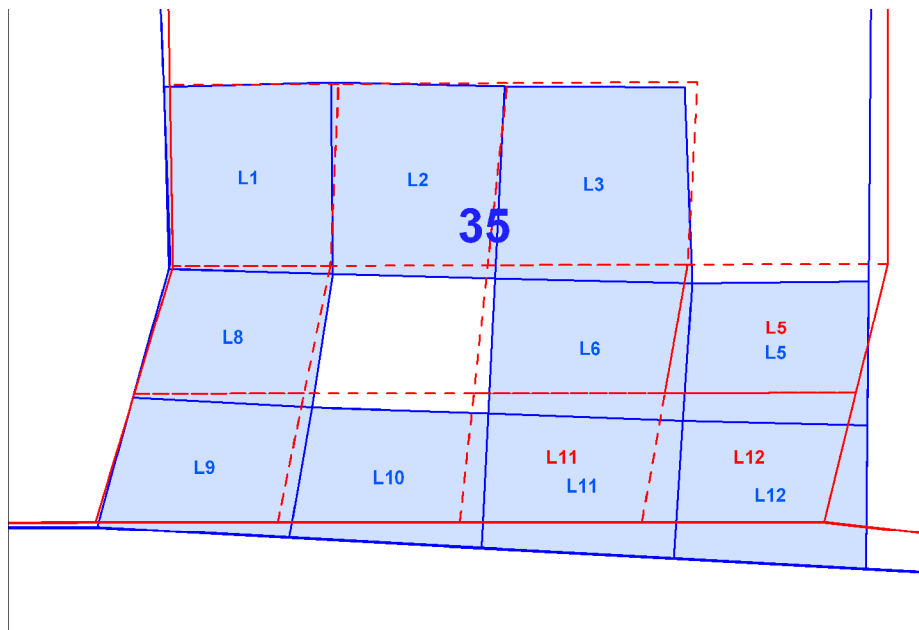

Wyoming BLM Lots Transformed to Target IHS PLSS Grid (Courtesy of IHS)



Infopipe® Information Services, Inc www.infopipe.com
info@infopipe.com 303-973-7459 Fax: 720-981-5668

Microsoft®
CERTIFIED
Partner